



GLASS PROFILE KT 11500

KT 11500	MILL FINISH	MAT ANODISE	BRIGHT ANODISE	STAINLESS STEEL EFFECT	RAL COLOURED
Length	Code	Code	Code	Code	Code
2500 MM	11500.250.10	11500.250.20	11500.250.30	11500.250.40	11500.250.50
5000 MM	11500.500.10	11500.500.20	11500.500.30	11500.500.40	11500.500.50



CORNER 90°

KT 11500	MILL FINISH	MAT ANODISE	BRIGHT ANODISE	STAINLESS STEEL EFFECT	RAL COLOURED
INSIDE	Code	Code	Code	Code	Code
	11500.100.10	11500.100.20	11500.100.30	11500.100.40	115 0.100.50



CORNER 90°

KT 11500	MILL FINISH	MAT ANODISE	BRIGHT ANODISE	STAINLESS STEEL EFFECT	RAL COLOURED
OUTSIDE	Code	Code	Code	Code	Code
	11500.110.10	11500.110.20	11500.110.30	11500.110.40	11500.110.50



END CAP

KT 11500	MILL FINISH	MAT ANODISE	BRIGHT ANODISE	STAINLESS STEEL EFFECT	RAL COLOURED
LEFT / RIGHT	Code	Code	Code	Code	Code
	11500.120.10	11500.120.20	11500.120.30	115 0.120.40	11500.120.50

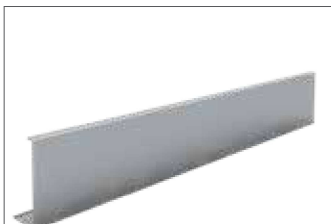

GLASS PROFILE COVER

KT 11500	MILL FINISH	MAT ANODISE	BRIGHT ANODISE	STAINLESS STEEL EFFECT	RAL COLOURED
Length	Code	Code	Code	Code	Code
2500 MM	9315.250.10	9315.250.20	9315.250.30	9315.250.40	9315.250.50
5000 MM	9315.500.10	9315.500.20	9315.500.30	9315.500.40	9315.500.50



Glassmove®

Glass Thickness	Colour	5000 MM	PCS
		Code	Code
20 - 21.52 mm	RED	KT.GM 5000.020.00	KT.GM 0001.020.02
24 - 25.52 mm	BLUE	KT.GM 5000.024.00	KT.GM 0001.024.02
30 - 31.52 mm	GREEN	KT.GM 5000.030.00	KT.GM 0001.030.02

INSTALLATION PART I

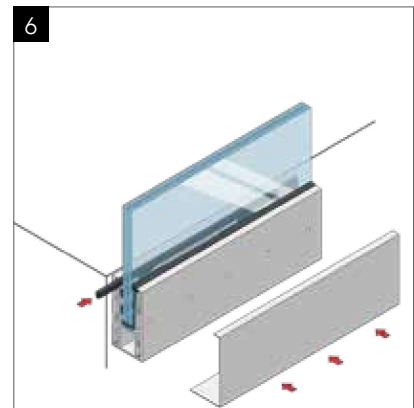
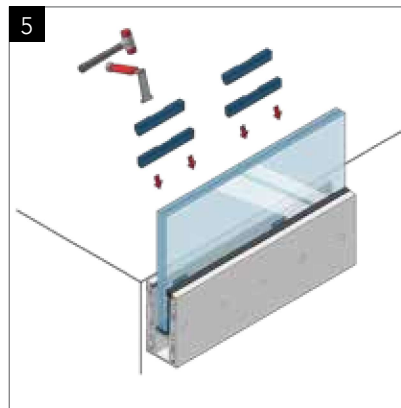
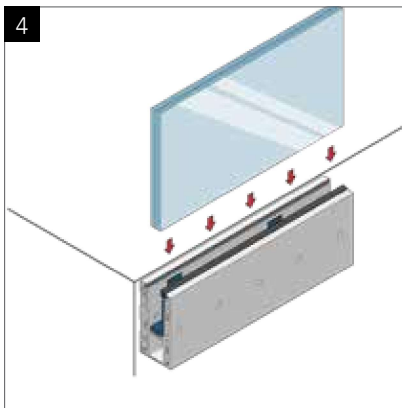
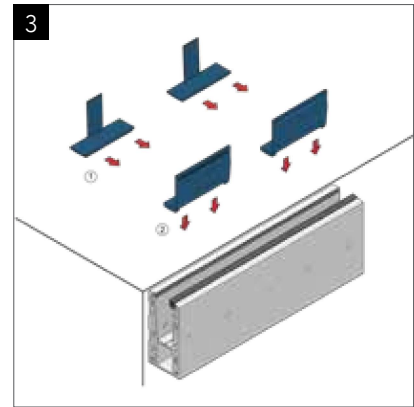
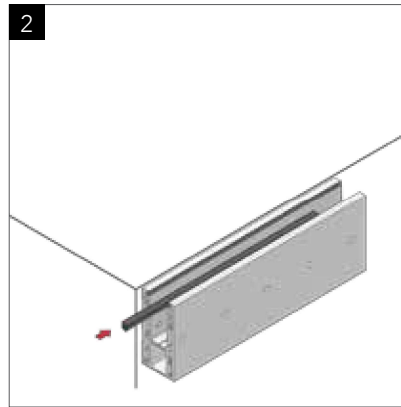
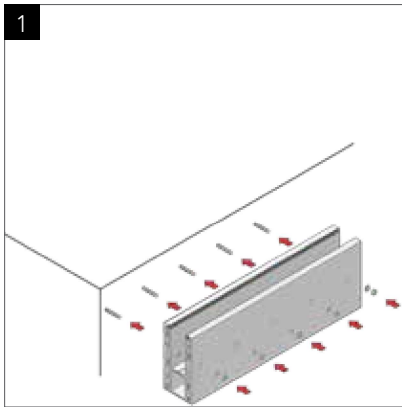

INSTALLATION PART II

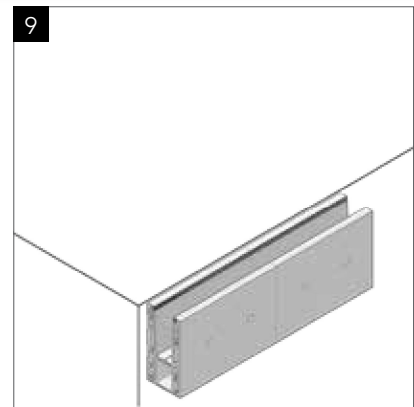
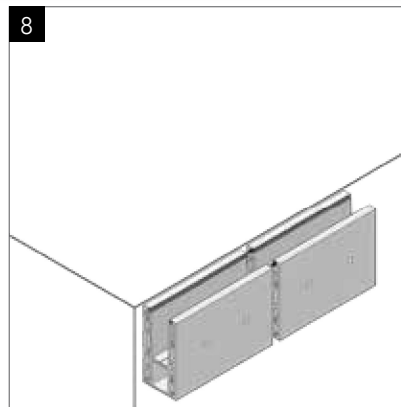
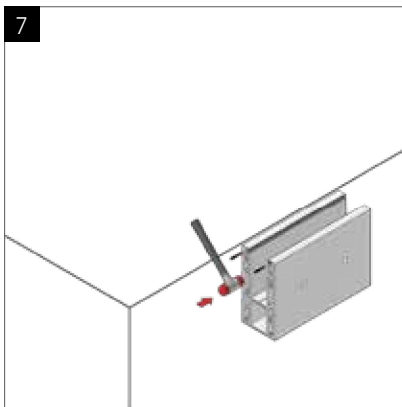

INSTALLATION PART III

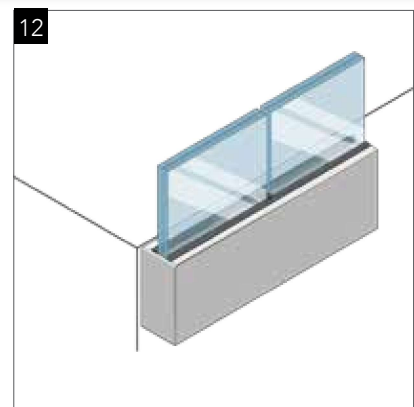
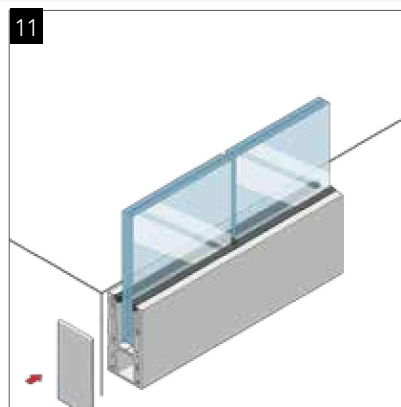
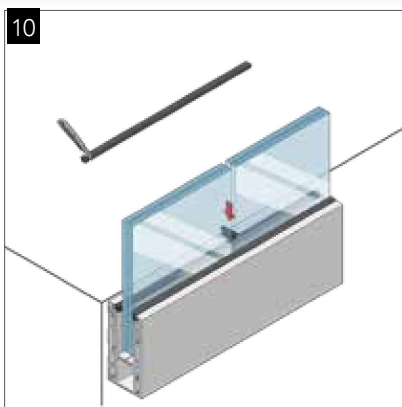

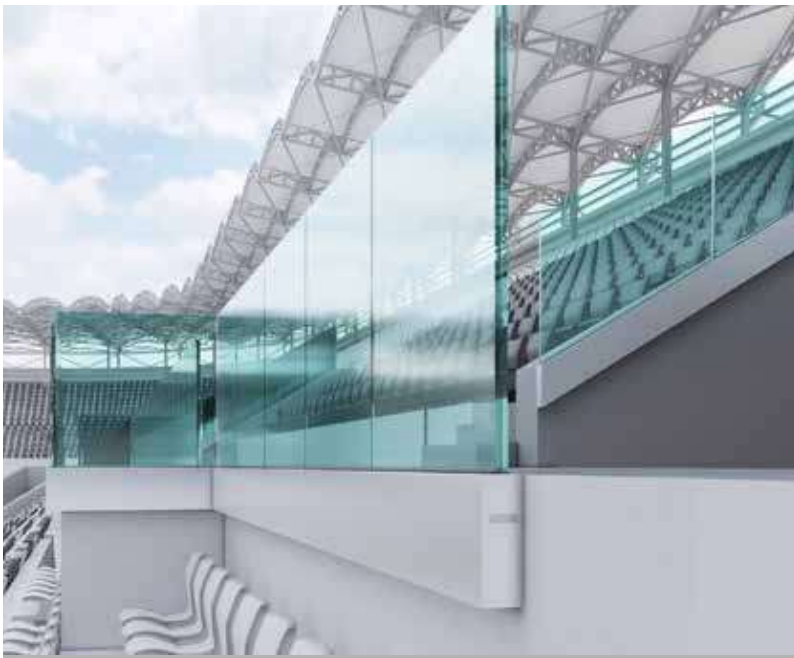

LOAD CAPACITY

EN: Aluminum alloy EN AW 6063 displacement results for 1 mt base profile under 300 kg (3000 nt) horizontal load to the highest surface of the profile.

FR: Alliage d'aluminium EN AW 6063 résultats de déplacement pour un profil de base de 1 mt sous une charge horizontale de 300 kg (3000 nt) sur la surface la plus élevée du profil.

DE: Die Verschiebung der Aluminiumlegierung EN AW 6063 ergibt ein Grundprofil von 1 m bei einer horizontalen Belastung von 300 kg (3000 nt) auf die höchste Oberfläche des Profils.



Glassmove® INFO

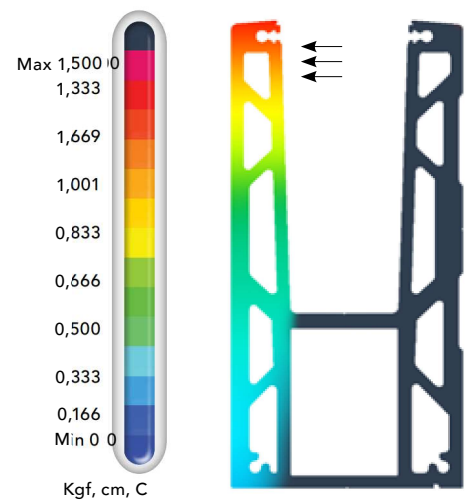
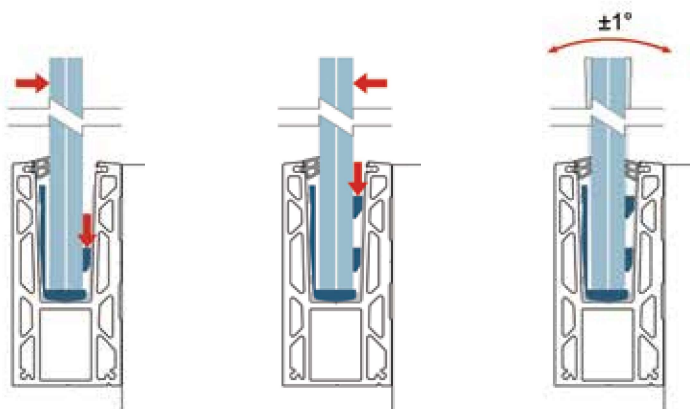

Displacement Values

ANCHORING POSSIBILITY FOR THE KT - 11500

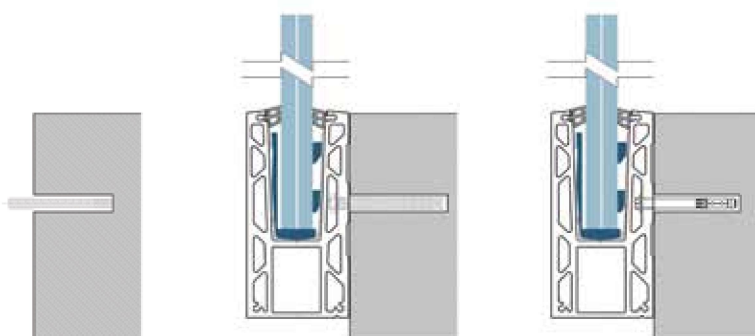

DRAINAGE DETAILS

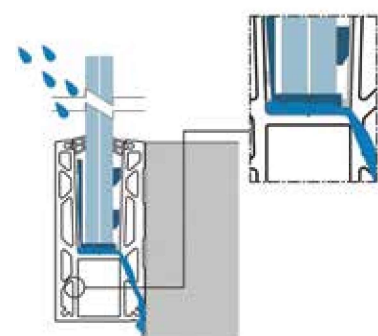

KT 11500



EN: The **Glassmove®** mechanism, which provides flexibility for the glass is available in the KT series. The KT 11500 series was developed and structured in line with the recommendation and demands of architectures in the application field, and it may be used in larger projects such as airports and stadiums.

Thickness of the glass may be selected optionally between 20 -31,52 millimeters.

FR: Le mécanisme **Glassmove®**, qui offre de la flexibilité pour le verre, est disponible dans la série KT. La série KT 11500 a été développée et structurée conformément aux recommandations et aux exigences des architectures dans le domaine, et peut être utilisée dans des grands projets tels que les stades et les aéroports.

L'épaisseur du verre peut être choisie en option entre 20 et 31,52 millimètres.

DE: Der **Glassmove®**-Mechanismus, der Flexibilität für das Glas bietet, ist in der KT-Serie erhältlich. Die KT 11500-Serie wurde gemäß den Empfehlungen und Anforderungen von Architekturen im Anwendungsbereich entwickelt und strukturiert und kann in größeren Projekten wie Stad'en und Flughafen.

Die Dicke des Glases kann optional zwischen 20 und 31,52 Millimetern gewählt werden.



KT 11500 CODES

- KT11500.250.00
- KT11500.500.00

PROFILE DRAWING

